

Technical data

Home distribution board DIDO-E

Technical data

Degree of protection	IP 40*
Colour	white
Double insulation	<input type="checkbox"/>
Standard	IEC 62208, IEC 60670-1, IEC 60670-24
Installation temperature	-25° / +60°C
Glow wire test	650°C

*IP 30 for EC 1+1, 3+1, 3+2, ECGxxMEDIA

Number of N - PE terminals:

ECT/M8PT/PO	2x8...8 PE / 8 N
ECT/M12PT/PO	2x10 10 PE / 10 N
ECT/M18PT/PO	2x13 13 PE / 13 N
ECT/M24PT/PO	2x13 13 PE / 13 N
ECT/M36PT/PO	2x15 15 PE / 15 N
ECT48PT/PO	2x20 20 PE / 20 N
ECT/M 2x18PT/PO	2x15 15 PE / 15 N
ECT/M 3x18PT/PO	2x25 25 PE / 25 N
ECG14	2x10 10 PE / 10 N
ECG28	2x13 13 PE / 13 N
ECG42	2x15 15 PE / 15 N
ECG56	2x20 20 PE / 20 N
ECG70	2x30 30 PE / 30 N
EC 1+1	-
EC 3+1	-
EC 3+2	2x4 4 PE / 4 N

- ECG14, ECG28, ECG42 have 1 additional free space to build in an extra PST-UNI terminal.

- ECG56 has 3 additional free spaces to build in up to 3 extra PST-UNI terminals.

- Double insulation not valid for ECG MEDIA

Surface mounted distribution board

type	Dimensions					Max. allowed power losses when Max. number of devices are installed Pde
	A	B	C	D	E	
ECT8PT/ECT8PO	236 mm	215 mm	112 mm	107 mm	108 mm	14W
ECT12PT/ECT12PO	236 mm	287 mm	112 mm	107 mm	180 mm	22W
ECT18PT/ECT18PT	236 mm	396 mm	112 mm	107 mm	289 mm	22W
ECT24PT/ECT24PO	361 mm	287 mm	112 mm	232 mm	180 mm	24W
ECT36PT/ECT36PO	482 mm	287 mm	112 mm	357 mm	180 mm	26W
ECT48PT/ECT48PO	652 mm	287 mm	112 mm	357 mm	180 mm	28W
ECT2x18PT/ECT2x18PO	361 mm	396 mm	112 mm	232 mm	289 mm	26W
ECT3x18PT/ECT3x18PO	526 mm	396 mm	112 mm	357 mm	289 mm	26W

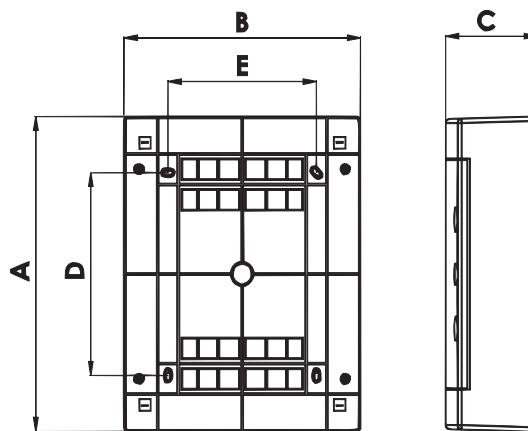

Flush mounted distribution board

type	Dimensions							Max. allowed power losses when Max. number of devices are installed Pde
	A	B	C	D	E	F	G	
ECM8PT/ECM8PO	212 mm	201 mm	68 mm	-	211 mm	232 mm	99 mm	14W
ECM12PT/ECM12PO	212 mm	273 mm	68 mm	-	283 mm	232 mm	106 mm	22W
ECM18PT/ECM18PO	212 mm	373 mm	68 mm	-	392 mm	232 mm	106 mm	22W
ECM24PT/ECM24PO	336 mm	273 mm	68 mm	125 mm	283 mm	357 mm	106 mm	24W
ECM36PT/ECM36PO	460 mm	273 mm	68 mm	125 mm	283 mm	482 mm	106 mm	26W
ECM2x18PT/ECM2x18PO	336 mm	373 mm	68 mm	125 mm	392 mm	357 mm	106 mm	26W
ECM3x18PT/ECM3x18PO	502 mm	373 mm	68 mm	125 mm	392 mm	522 mm	106 mm	26W

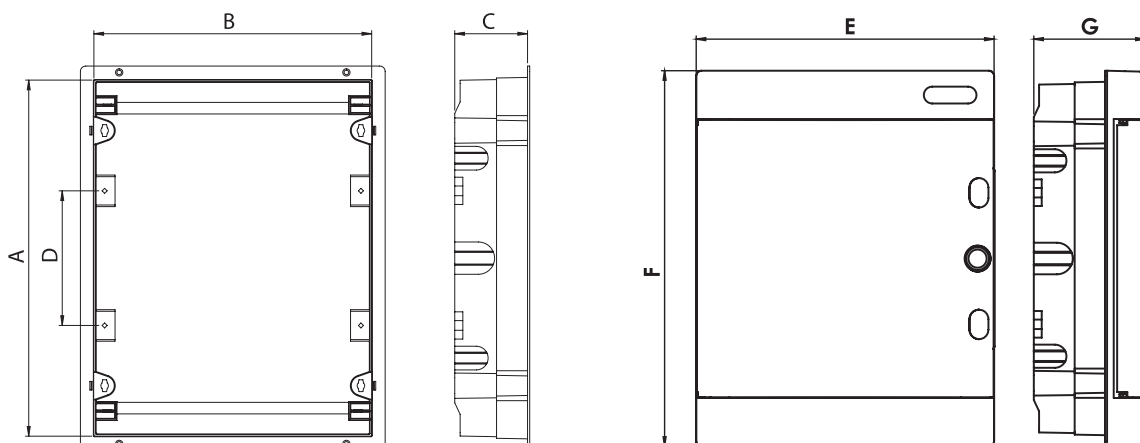

Flush mounted distribution board

type	Dimensions					Max. allowed power losses when Max. number of devices are installed Pde
	A	B	C	H	W	
ECG14	274 mm	306 mm	87 mm	317 mm	346 mm	31W
ECG28	399 mm	306 mm	87 mm	442 mm	346 mm	40W
ECG42	549 mm	306 mm	87 mm	592 mm	346 mm	50W
ECG56	673 mm	306 mm	87 mm	717 mm	346 mm	60W
ECG70	806 mm	317 mm	87 mm	842 mm	346 mm	60W

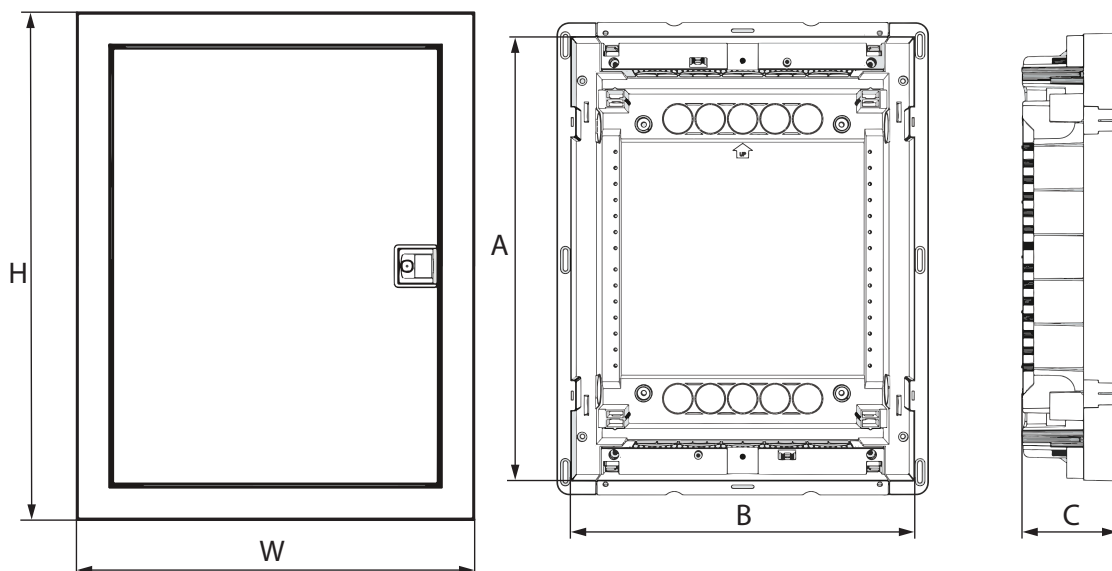

Surface mounted distribution board - IP30

type	Dimensions	Number of modules
EC 1+1	137 x 51 x 57	1 (+1)
EC 3+1	137 x 87 x 57	3 (+1)
EC 3+2	97 x 155 x 57	3 (+2)

ECG	
Material	Acrylonitrile butadiene styrene
Color	RAL9003
Door	Acrylonitrile butadiene styrene
Color	Transparent & white
Glow wire test	650°C
Terminal holder	Self extinguish material (Glow wire test: 960°C)
Temperature	-25°C ... +60°C
Rated voltage	AC400V
Standard	IEC60670
Halogen free	✓

ECG_H	
Material	Acrylonitrile butadiene styrene
Color	RAL9003
Door	Metal
Color	white
Glow wire test	850°C
Terminal holder	Self extinguish material (Glow wire test: 960°C)
Temperature	-25°C ... +60°C
Rated voltage	AC400V
Standard	IEC 60670-1, IEC 60670-24
Halogen free	✓

Advantages

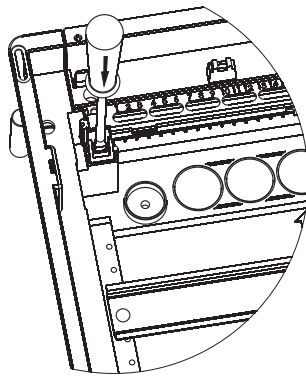

Easy terminal mounting

Left or right door mounting

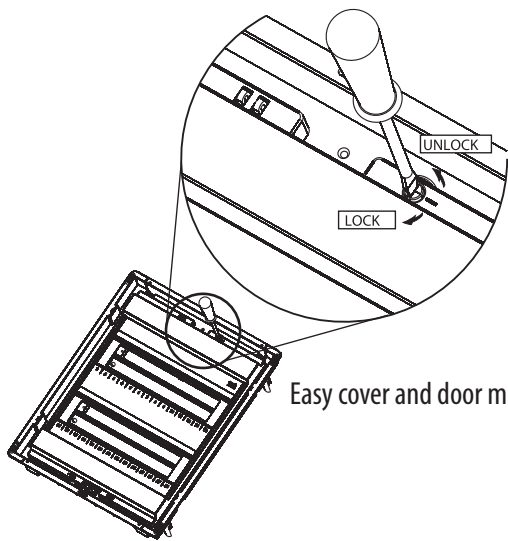
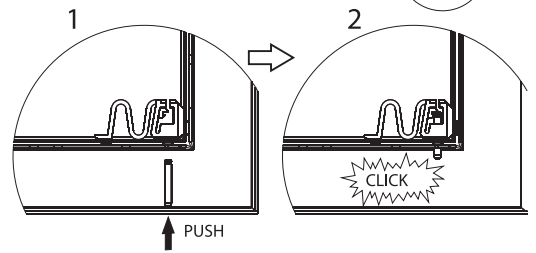
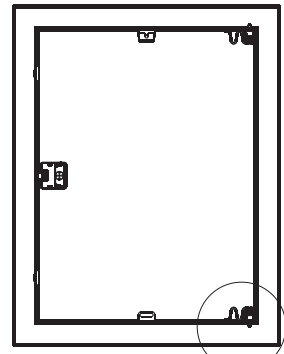

Easy cover and door mounting

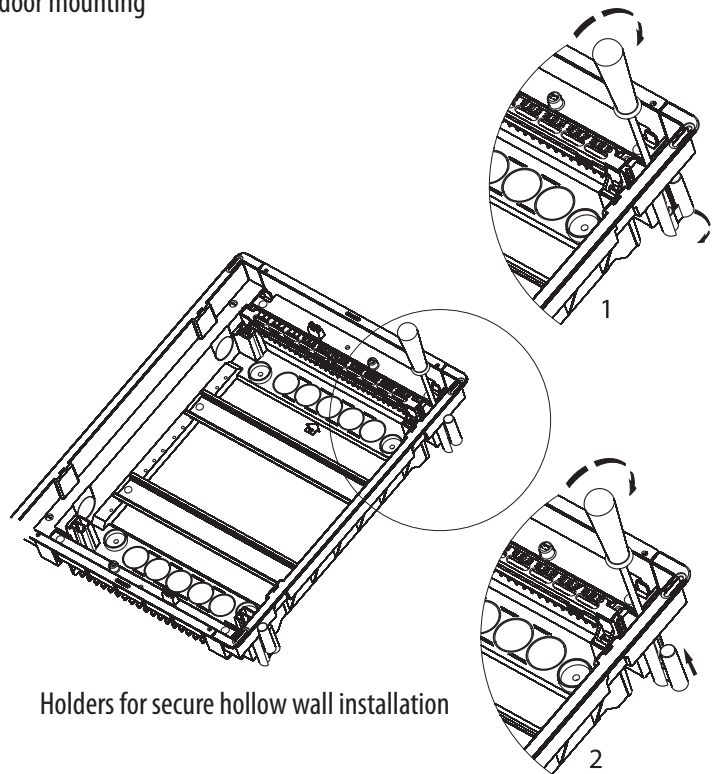

Holders for secure hollow wall installation

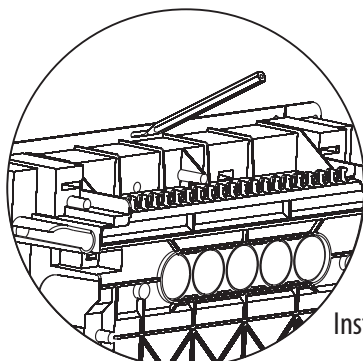

Installation marking slots for hollow walls

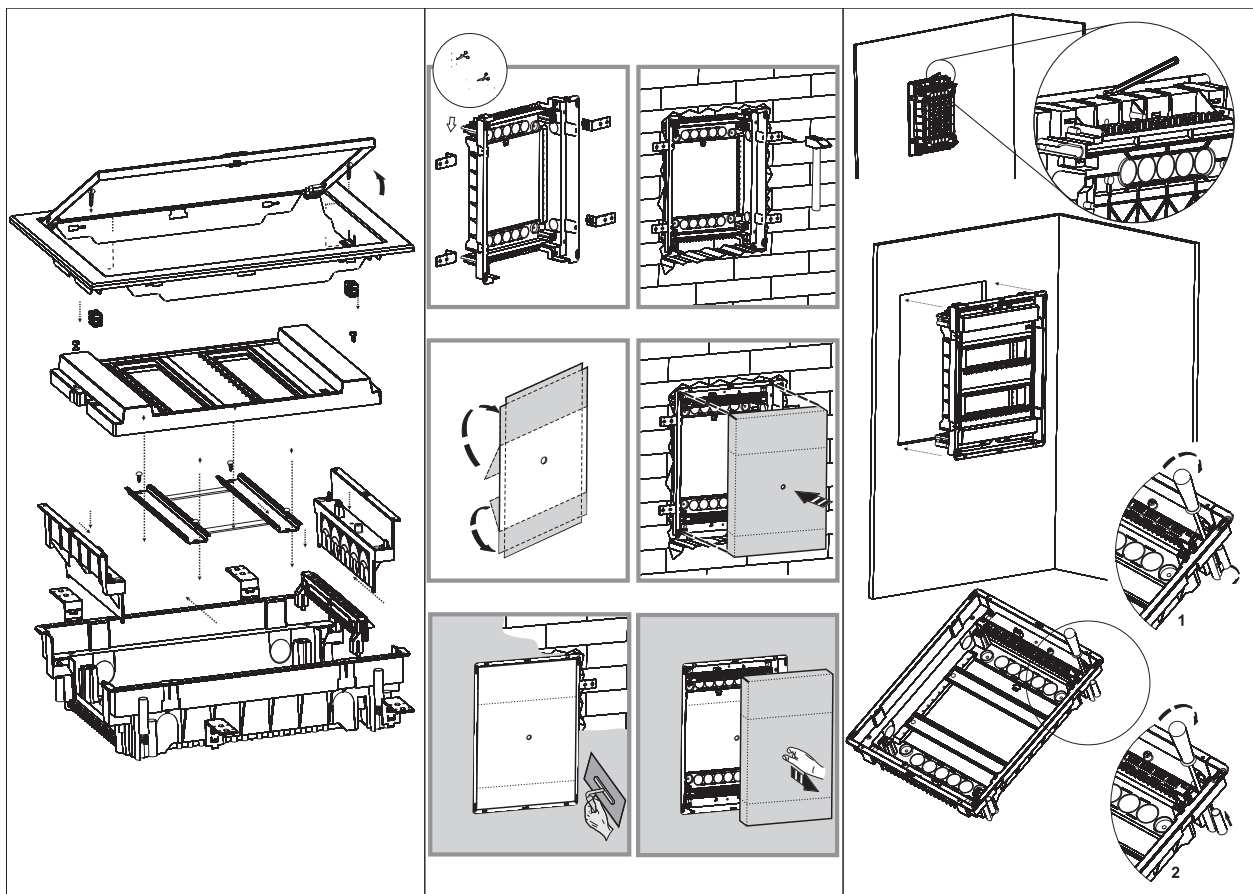

Flush mounted enclosures DIDO ERP

Part no.	Description
1	frame with doors
2	Plastic covers
3	TH set
4	PE/N terminals
5	bottom of enclosure
6	fixing elements

Glow wire test: 650°C

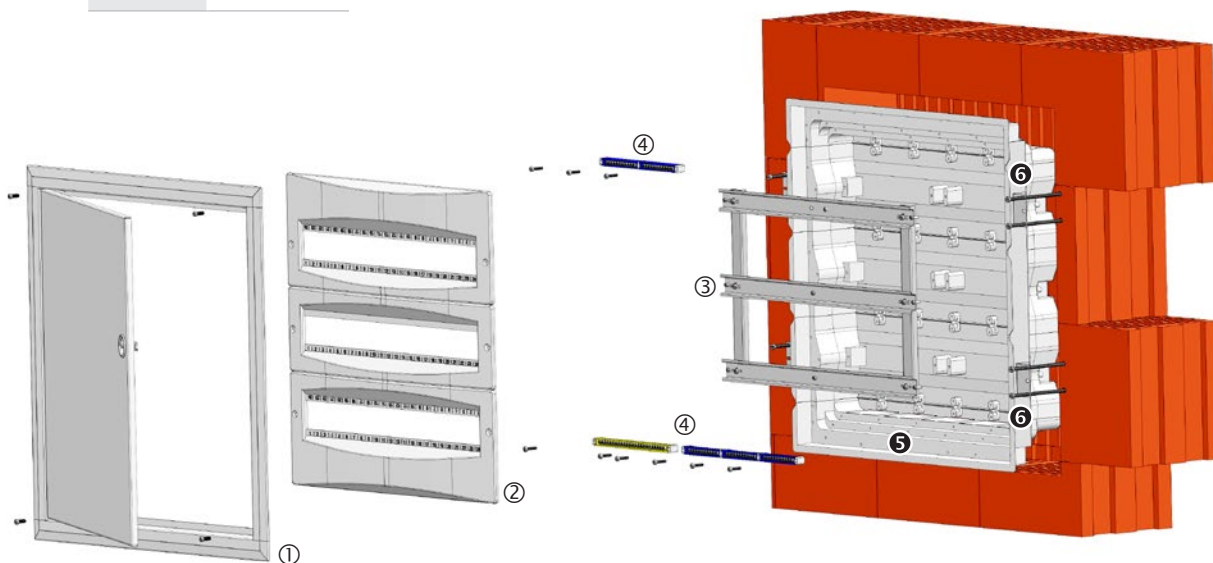

Technical data

Dimensions

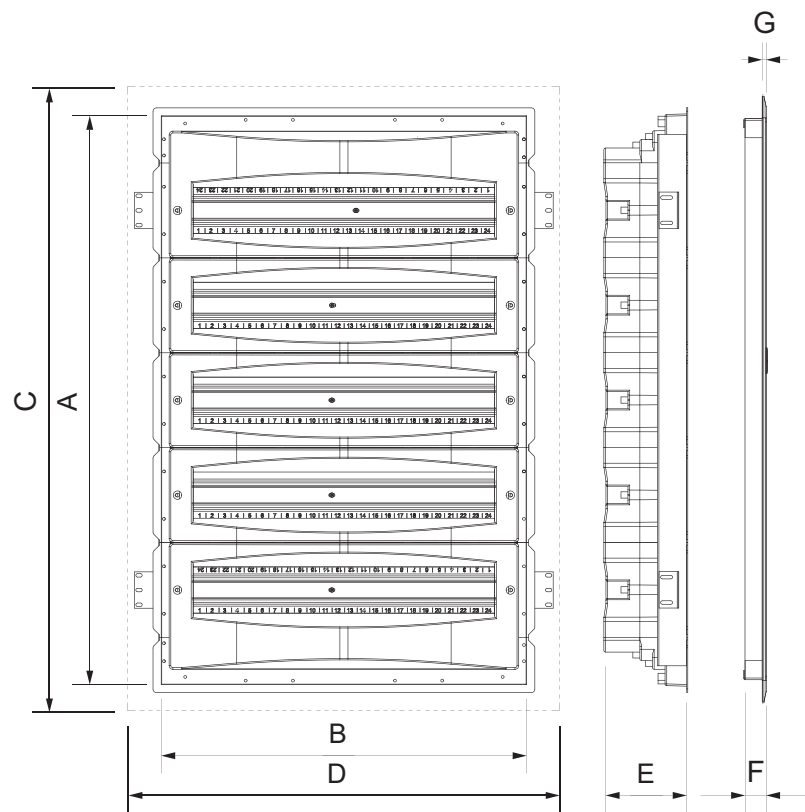

	A [mm]	B [mm]	C [mm]	D [mm]	E [mm]	F [mm]	G [mm]
ERP24-2	408	523	465	575	120	30	5
ERP24-3	543	523	600	575	120	30	5
ERP24-4	678	523	735	575	120	30	5
ERP24-5	813	523	870	575	120	30	5
ERP24-6	948	523	1005	575	120	30	5

Distribution boards DIDO ACT

DIDO ACT	
Material	ABS
Color	RAL9003
Door	styrene acrylonitrile
Color	Transparent & white
Glow wire test	650°C
Terminal holder	Self extinguish material (Glow wire test: 960°C)
Temperature	-25°C ... +60°C
Rated voltage	AC400V
Standard	IEC 62208, IEC 60670-1, IEC60670-24
Halogen free	✓

Dimensions

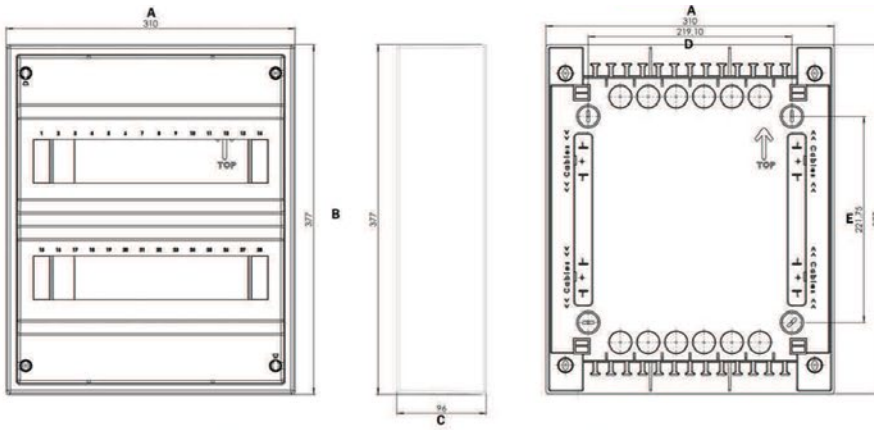

	A [mm]	B [mm]	C [mm]	D [mm]	E [mm]	Max. allowed power losses when Max. number of devices are installed
ACT12	310	251	96	96	219	30W
ACT24	310	377	96	219	222	40W
ACT36	310	502	96	219	347	60W

Modular distribution board for use outside DIDO-ECH

Technical data

Degree of protection	IP 65
Insulation class	II
Colour	RAL 7035
Double insulation	<input type="checkbox"/>
Standard	IEC 60670-1, IEC 60670-24
Installation temperature	-20° / +60°C
Glow wire test	650°C

Dimensions

type	Dimensions						Max. allowed power losses when Max. number of devices are installed Pde
	A	B	C	D	E	F	
ECH-4G	201 mm	128 mm	120 mm	-	78 mm	111 mm	10W
ECH-8G	201 mm	202 mm	120 mm	-	100 mm	140 mm	13W
ECH-12PT	259 mm	319 mm	144 mm	-	210 mm	130 mm	16W
ECH-24PT	384 mm	319 mm	144 mm	125 mm	210 mm	255 mm	24W
ECH-36PT	508 mm	319 mm	144 mm	125 mm	210 mm	380 mm	26W

Number of PE - N terminals:

4-G	2x4	4 PE / 4 N
8-G	2x8	8 PE / 10 N
12-PT	2x10	10 PE / 10 N
24-PT	2x15	15 PE / 15 N
36-PT	2x15	15 PE / 15 N

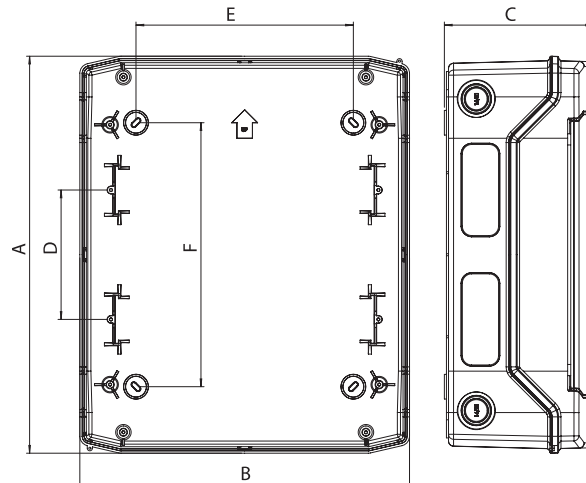

Metal enclosures GT type, IP65

Compliance with standards and directives:

EN 62208 Empty enclosures for low voltage switchgear and controlgear

EN 60529 Degrees of protection provided by enclosures (IP Code)

EN 62262 Degrees of protection against external mechanical impacts provided by enclosures of electrical equipment (IK code)

Meet the requirements of the RoHS Directive

Marked CE

The enclosures are supplied with:

- Cable entry cover with mounting kit
- Mounting plate with mounting kit
- Door lock with, double-bit insert and key
- Cover holes
- Earthing set of grounding (without cable)

Symbols:

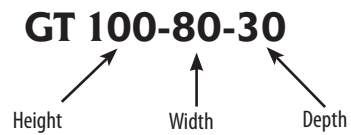

Type	Height Y (mm)	Width X (mm)	Depth Z (mm)	Lock quantity	Hinges quantity	Cable entry depth B1 (mm)	Cable entry width A1 (mm)	Cover cable entry depth B (mm)	Cover cable entry width A (mm)
GT 25-20-15	250	200	150	1	2	70	140	110	180
GT 30-20-15	300	200	150	1	2	70	140	110	180
GT 30-30-15	300	300	150	1	2	70	240	110	280
GT 30-30-20	300	300	200	1	2	120	240	160	280
GT 30-30-25	300	300	250	1	2	170	240	210	280
GT 40-30-15	400	300	150	1	2	70	240	110	280
GT 40-30-20	400	300	200	1	2	120	240	160	280
GT 40-30-25	400	300	250	1	2	170	240	210	280
GT 40-40-15	400	400	150	1	2	70	340	110	380
GT 40-40-20	400	400	200	1	2	120	340	160	380
GT 40-40-25	400	400	250	1	2	170	340	210	380
GT 40-60-20	400	600	200	1	2	120	540	160	580
GT 40-60-25	400	600	250	1	2	170	540	210	580
GT 40-60-30	400	600	300	1	2	170	540	210	580
GT 50-40-15	500	400	150	2	2	70	340	110	380
GT 50-40-20	500	400	200	2	2	120	340	160	380
GT 50-40-25	500	400	250	2	2	170	340	210	380
GT 50-55-20	500	550	200	2	2	120	490	160	530
GT 50-55-25	500	550	250	2	2	170	490	210	530
GT 60-40-15	600	400	150	2	2	70	340	110	380
GT 60-40-20	600	400	200	2	2	120	340	160	380
GT 60-40-25	600	400	250	2	2	170	340	210	380
GT 60-60-20	600	600	200	2	2	120	540	160	580
GT 60-60-25	600	600	250	2	2	170	540	210	580
GT 60-60-30	600	600	300	2	2	170	540	210	580
GT 60-80-30	600	800	300	2	2	170	740	210	780
GT 65-55-20	650	550	200	2	2	120	490	160	530
GT 65-55-25	650	550	250	2	2	170	490	210	530
GT 80-40-20	800	400	200	2	3	120	340	160	380
GT 80-40-25	800	400	250	2	3	170	340	210	380
GT 80-55-20	800	550	200	2	3	120	490	160	530
GT 80-55-25	800	550	250	2	3	170	490	210	530
GT 80-60-20	800	600	200	2	3	120	540	160	580
GT 80-60-25	800	600	250	2	3	170	540	210	580
GT 80-60-30	800	600	300	2	3	170	540	210	580
GT 80-60-40	800	600	400	2	3	170	540	210	580
GT 80-80-20	800	800	200	2	3	120	740	160	780
GT 80-80-25	800	800	250	2	3	170	740	210	780
GT 80-80-30	800	800	300	2	3	170	740	210	780
GT 80-80-40	800	800	400	2	3	170	740	210	780
GT 80-100-30	800	1000	300	2	3	170	940	210	980
GT 80-100-40	800	1000	400	2	3	170	940	210	980
GT 100-60-25	1000	600	250	3p*	3	170	540	210	580
GT 100-60-30	1000	600	300	3p*	3	170	540	210	580
GT 100-60-40	1000	600	400	3p*	3	170	540	210	580
GT 100-80-25	1000	800	250	3p*	3	170	740	210	780
GT 100-80-30	1000	800	300	3p*	3	170	740	210	780
GT 100-80-40	1000	800	400	3p*	3	170	740	210	780
GT 100-100-25	1000	1000	250	3p*	3	170	940	210	980
GT 100-100-30	1000	1000	300	3p*	3	170	940	210	980
GT 100-100-40	1000	1000	400	3p*	3	170	940	210	980
GT 120-60-25	1200	600	250	3p*	3	170	540	210	580
GT 120-80-25	1200	800	250	3p*	3	170	740	210	780
GT 120-80-30	1200	800	300	3p*	3	170	740	210	780
GT 120-80-40	1200	800	400	3p*	3	170	740	210	780
GT 120-100-30	1200	1000	300	3p*	3	170	940	210	980
GT 120-100-40	1200	1000	400	3p*	3	170	940	210	980

Technical data

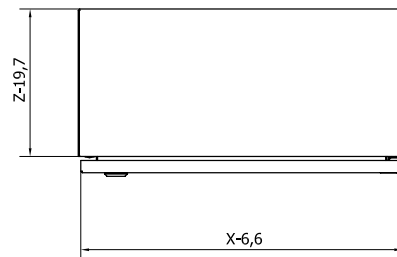
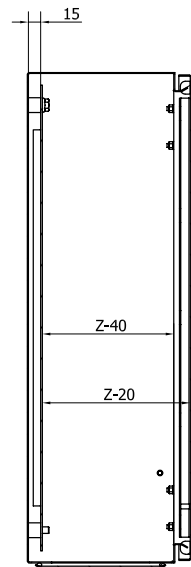
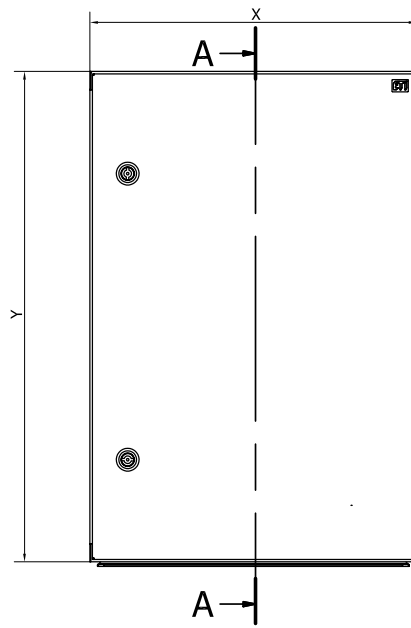
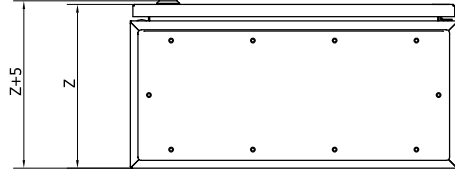
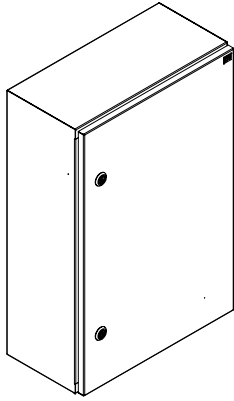

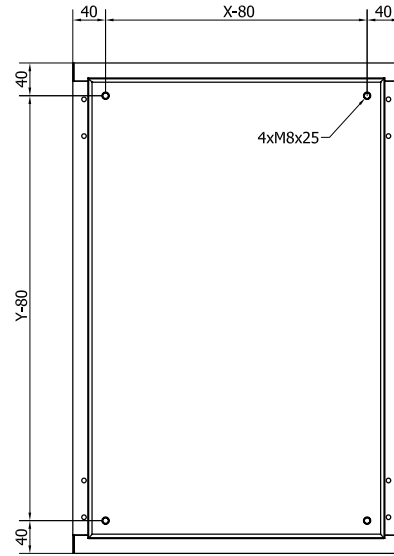
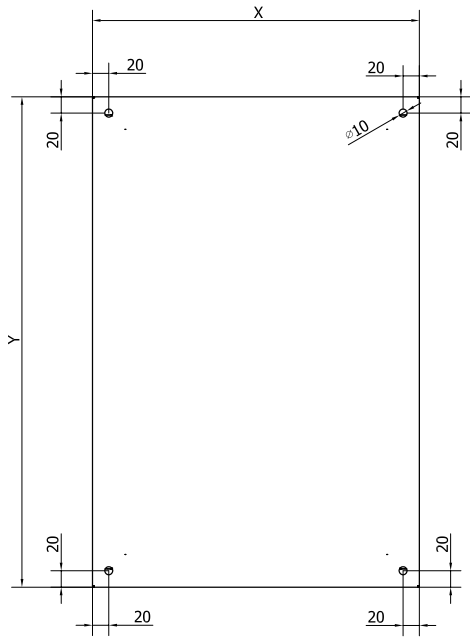

The door

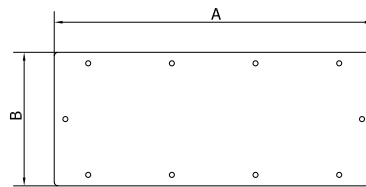
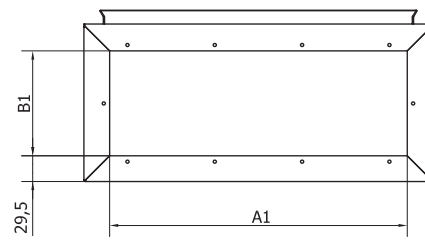
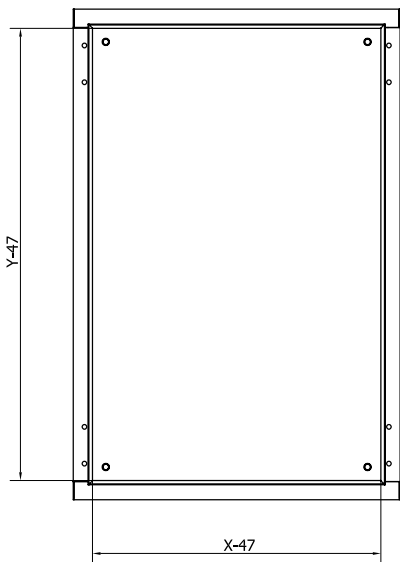

The cover of cable entry

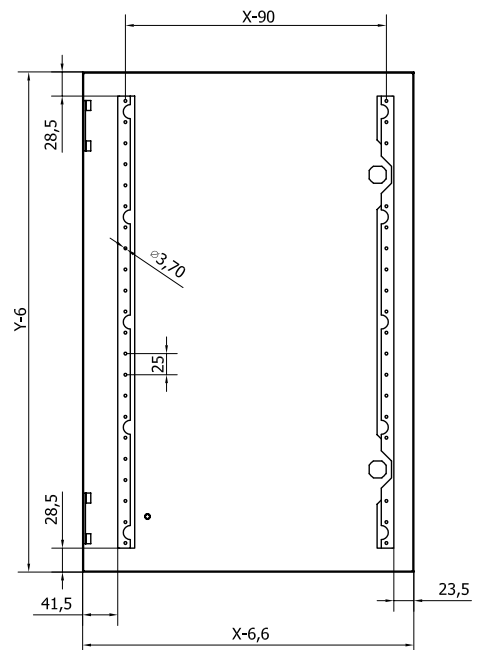
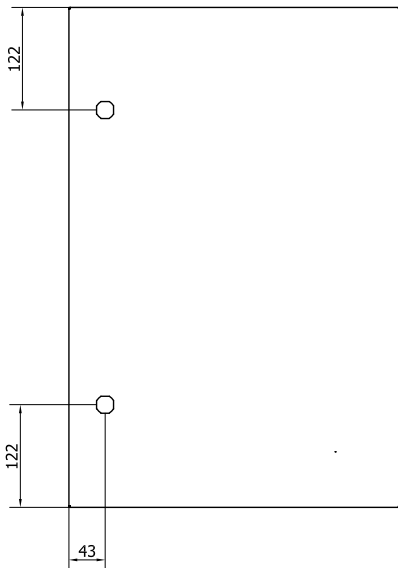

Technical data

The door

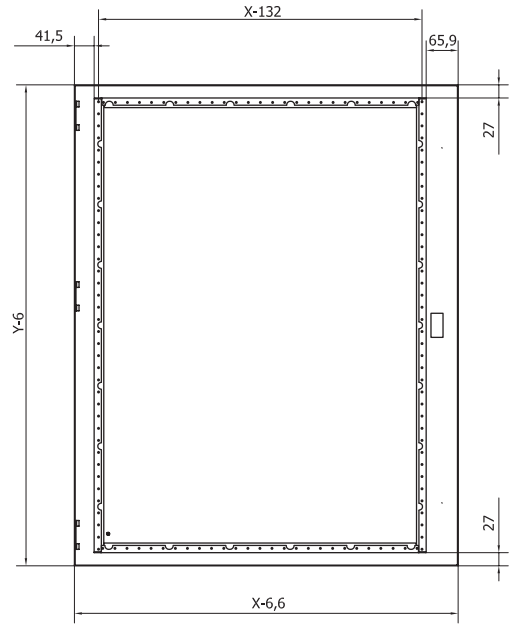
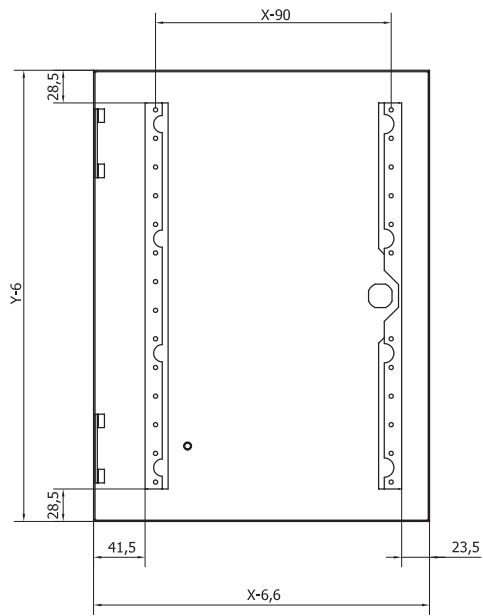

Wall holder

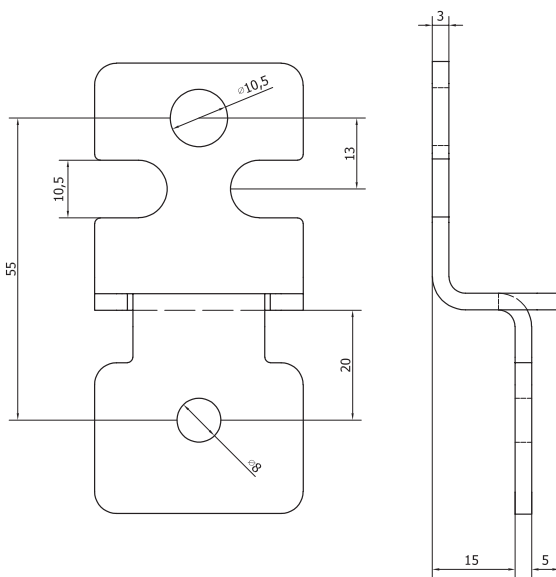

Mounting plate

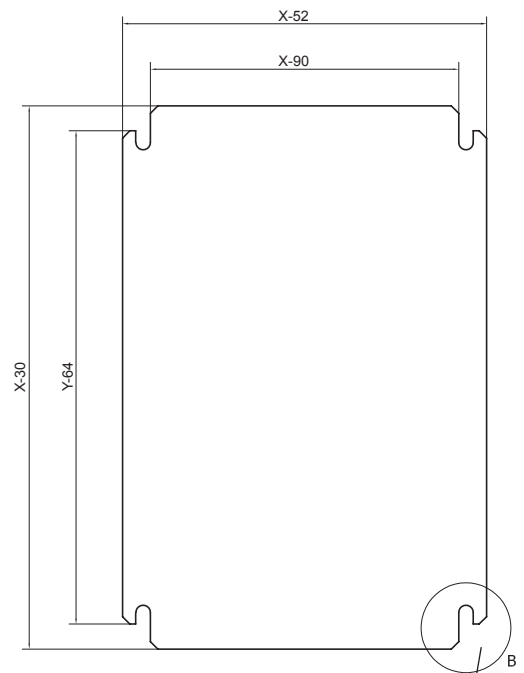

Door drilling

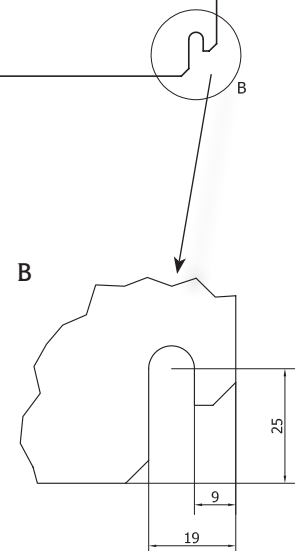
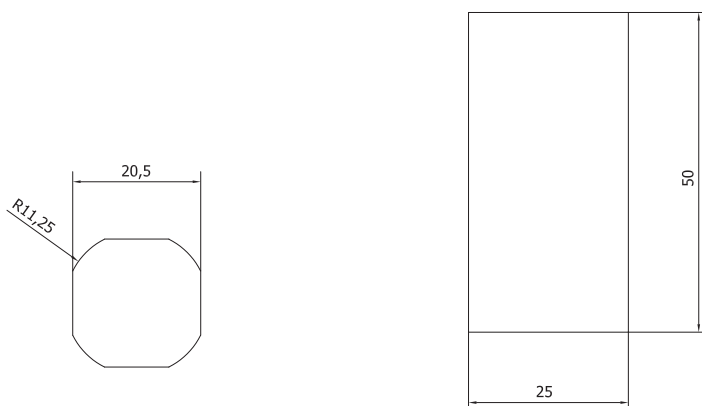

SB (S Box) Double insulation enclosures IP66, IK10

Technical data

IP protection degree	IP 66
IK protection degree	IK10 (≤ 20 kJ)
Double insulation	
Insulation class	II
Nominal voltage	1000V DC
Nominal current	1000 A
Installation temperature	-30°C ... +60°C
Colour	Base - grey (RAL 7035) / Lid - transparent
Flame resistance (UL 94)	Base - V0 / Lid - V2
Thermal resistance	Base - 960°C / Lid - 750°C
Standard	IEC 62208

Dimensions

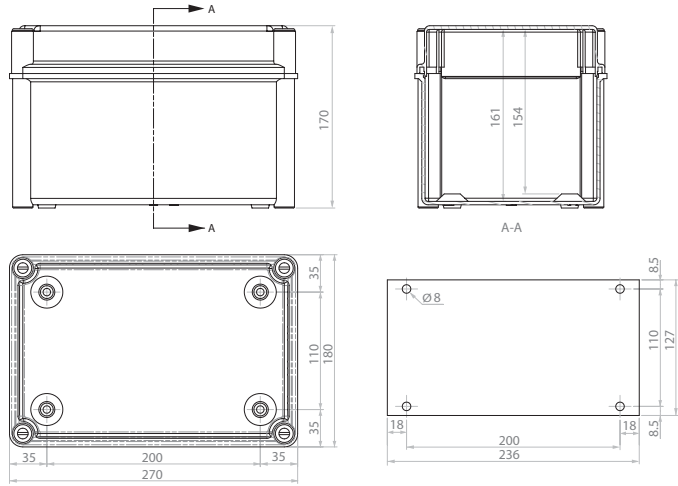

SB-32

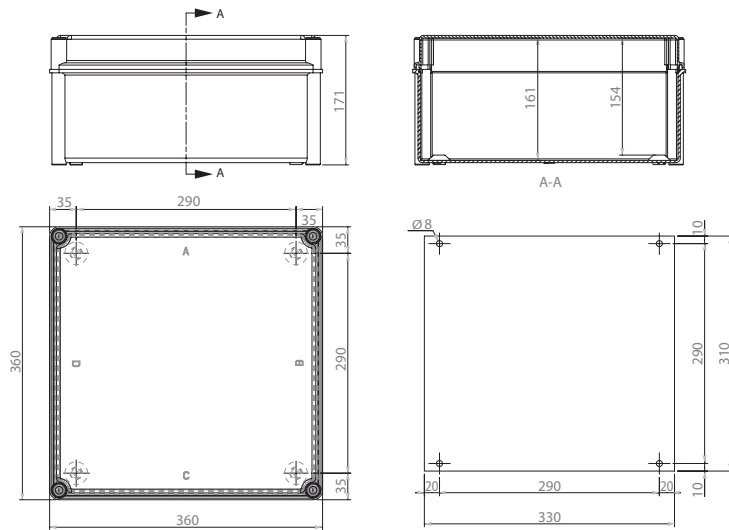

SB-44

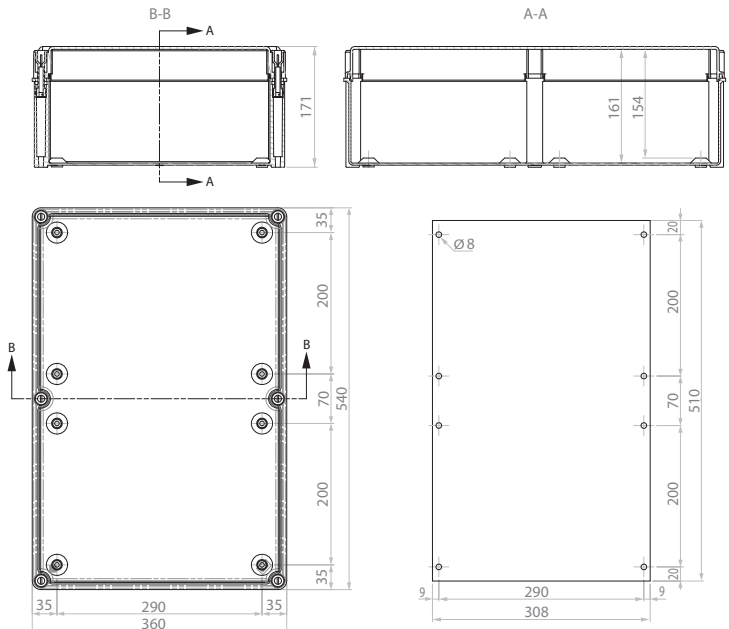

SB-64

Free-standing cable distribution cabinets

Electrical parameters

Rated operational voltage Un	400V
Rated insulation voltage Ui	690V
Flamability category	V0
Degree of protection against external mechanical impacts	IK 10
Protection degree	IP44
Protection class	II
Operating temperature	-25°C ... 40°C

Dimensions

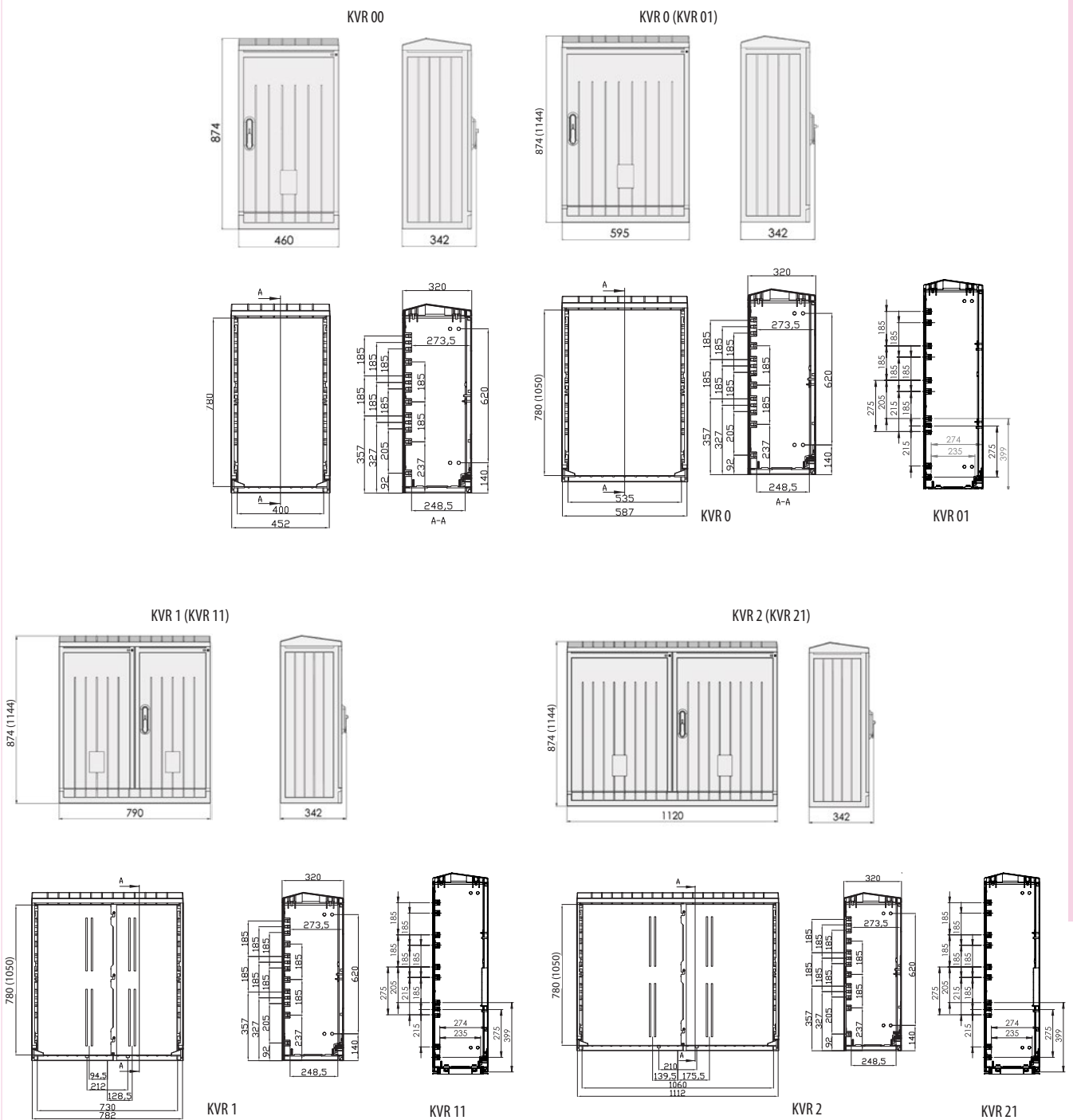

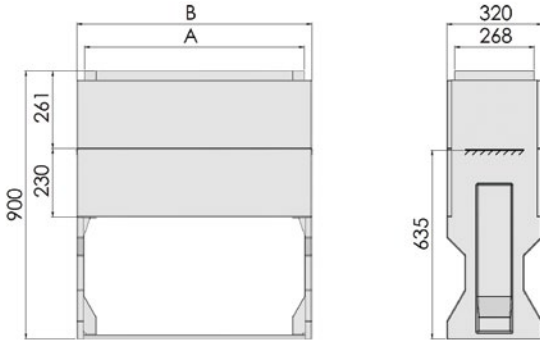

[mm]	A	B	C	D
KVR-P 00	408	460	360	332
KVR-P 0	543	595	495	467
KVR-P 1	738	790	690	662
KVR-P 2	1068	1120	1020	992

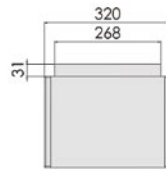
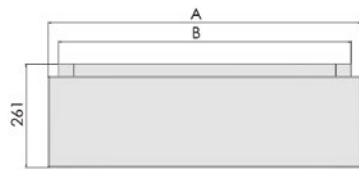
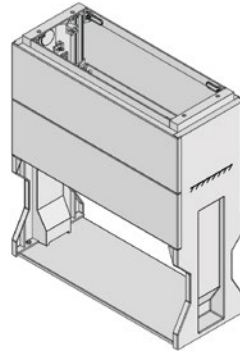
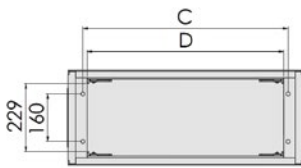

[mm]	A	B	C	D
KVR-PE 00	460	408	360	332
KVR-PE 0	595	543	495	467
KVR-PE 1	790	738	690	662
KVR-PE 2	1120	1068	1020	992

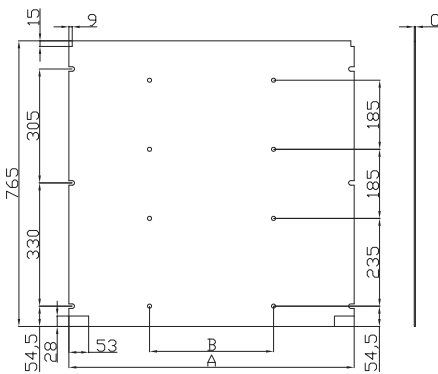
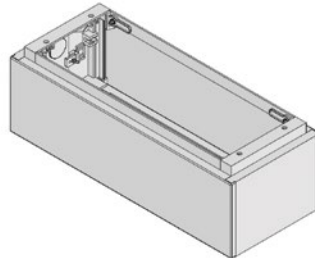
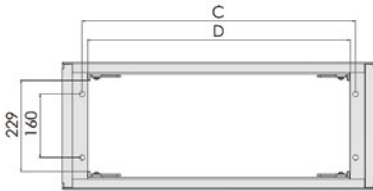

[mm]	A	B	C
KVR-MP 00	435	-	2
KVR-MP 0	572	-	2
KVR-MP 1	764	300	2
KVR-MP 2	1095	400	2

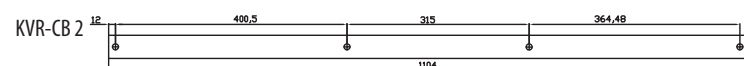
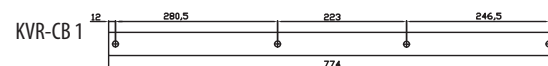
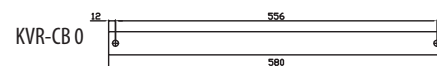
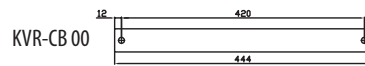

Technical data

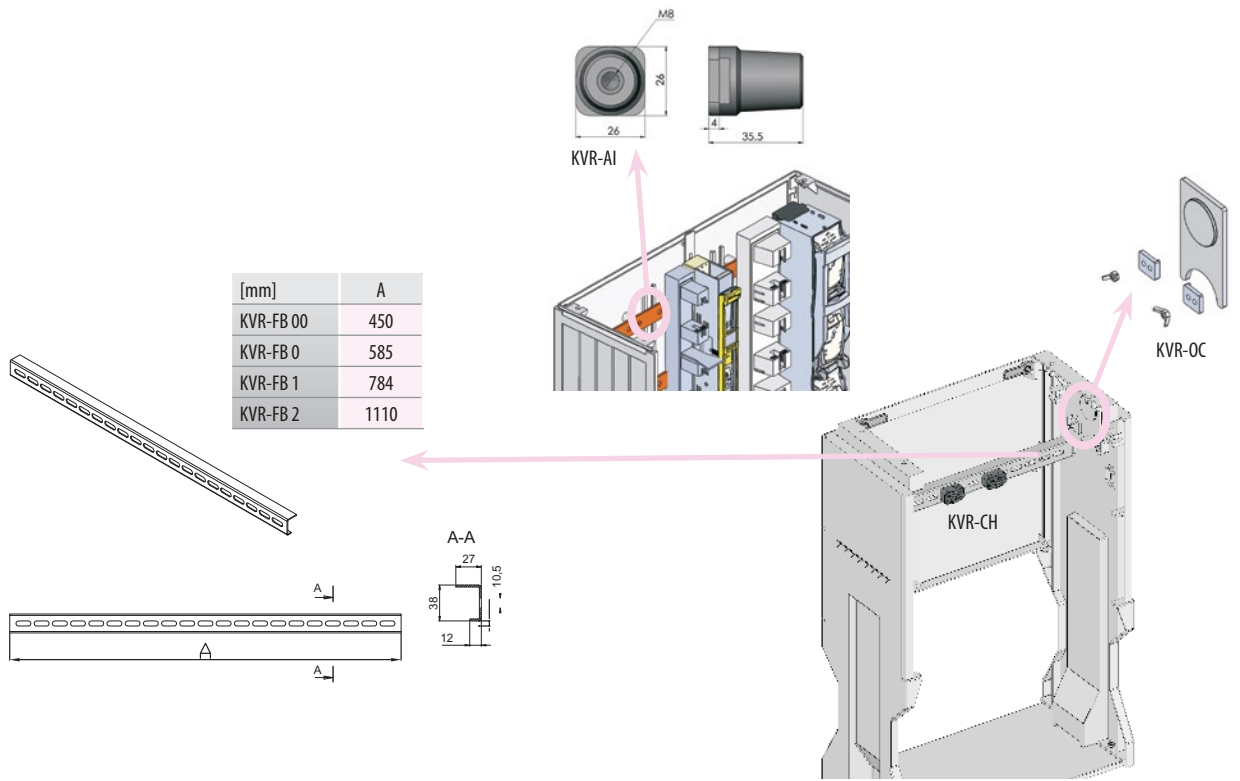

Enclosure ventilation

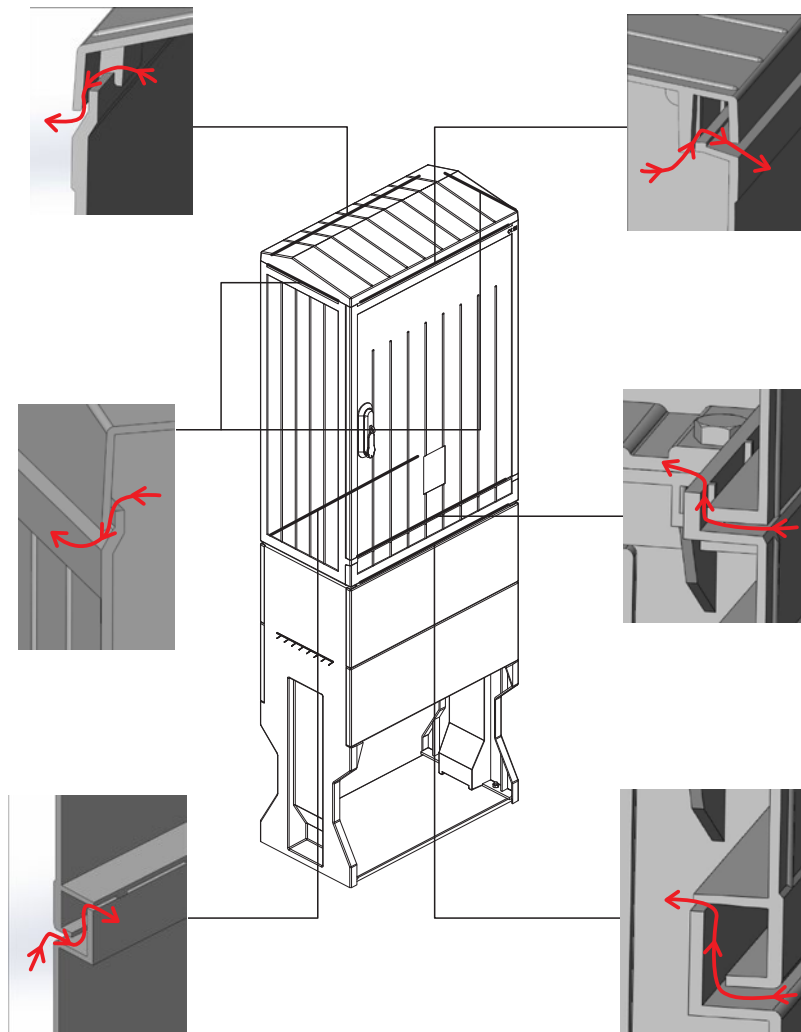

Accessories

Terminal for protective conductors

type	length [m]	supply [mm ²]	outlet [mm ²]
2/6	0,056	2 x 22	6 x 14
2/8	0,086	2 x 22	8 x 14
2/12	0,092	2 x 22	12 x 14
2/18	0,128	2 x 22	18 x 14

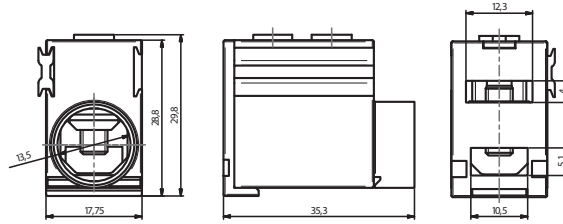

Technical data - Section rails for ETIMAT P10

Cross section	10 mm ²	16 mm ²	25 mm ²
Feeding at beginning/ending			
Max. current Is/Phase	63	80	100
Cross section of connection, mm ²	10	16	25
Feeding in the middle			
Max. current Ie/Phase	100	130	170
Cross section of connection, mm ²	25	35	2x25
Heat deflection temperature PVC	80°C flame resistant		
Comparative tracking index PVC	300V		
Standards	EN 60947-1:2007/ IEC 60947-1:2007		
Climate stability	DIN EN 60068		
Insulation coordination	Degree of pollution 2		
Electrical data			
Impulse voltage strength	≥4,5 kV		
Min. air distance	> 5,5 mm		
Min. creeping distance	> 5 mm		
Max. operating voltage	690 V AC/DC		
Protection class	IP20		
Short circuit rating	ICC 15kA NH 250A gL 500V		
Dielectric strenght	≥ 32 kV/mm		
Material			
	Material	Surface	
Busbar	Copper	plain	
Insulation	PVC lead-free	grey RAL 7035	
Endcover	moulded		

Ampacity at 35 °C ambient temperature depending of feeding point

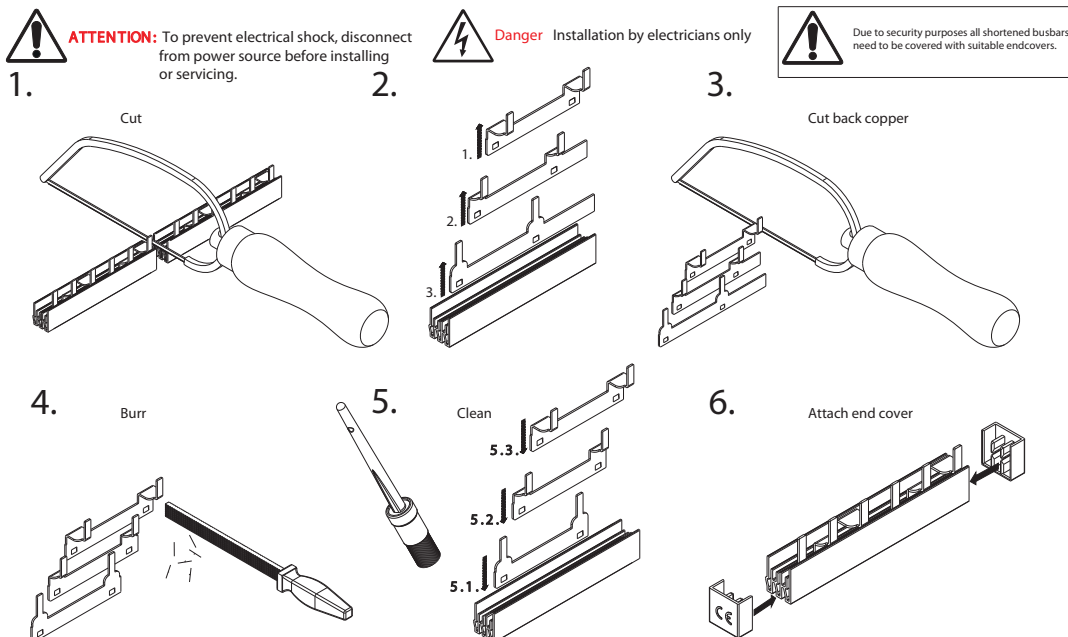

Technical data

Dimensions

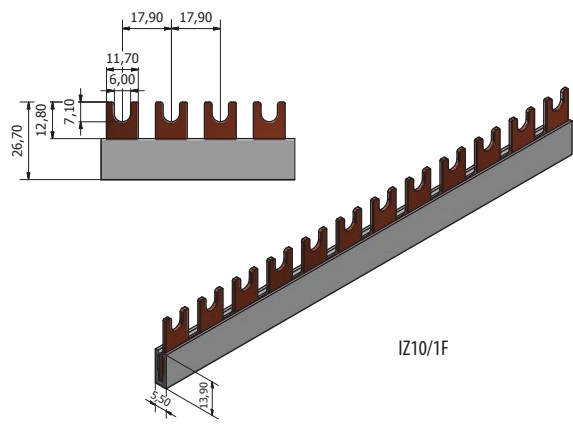
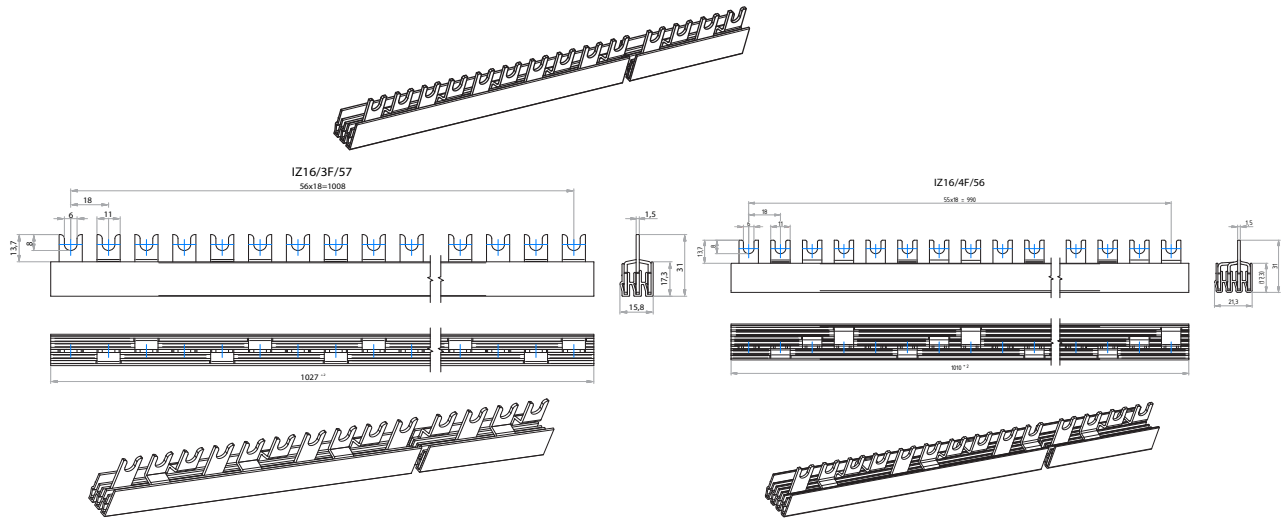
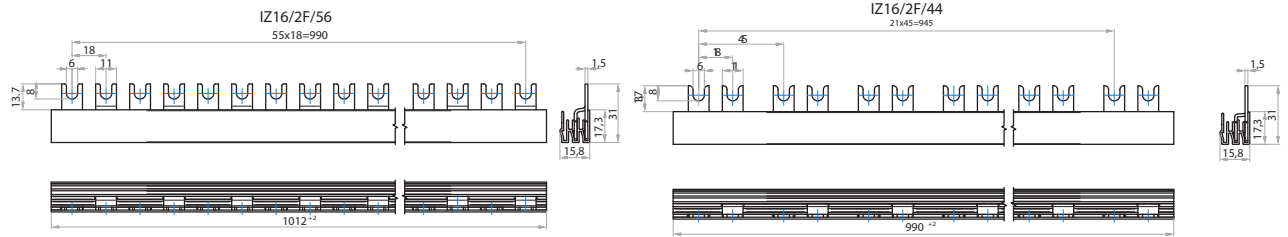

IZ10/1F

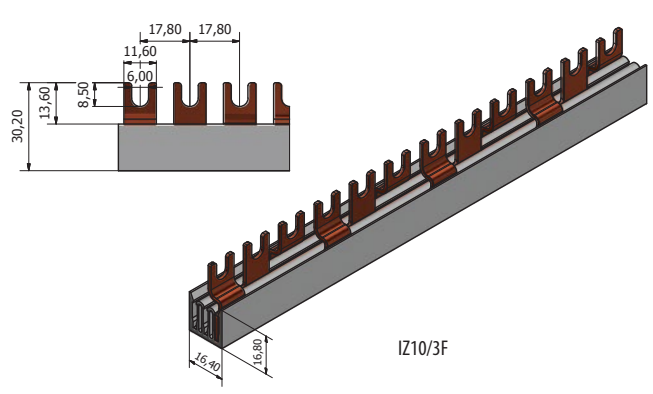

IZ10/3F

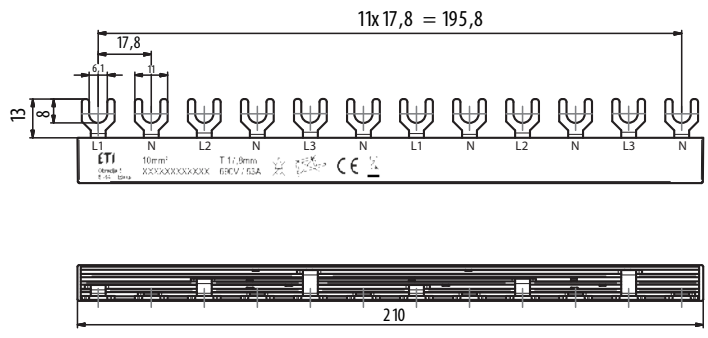

IZ10/L1NL2NL3N/12

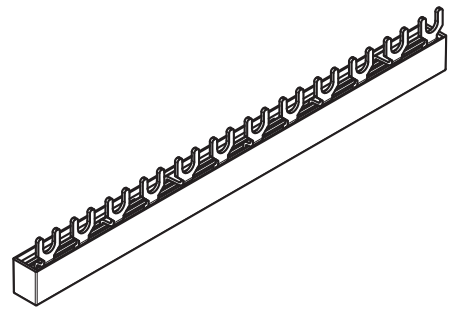

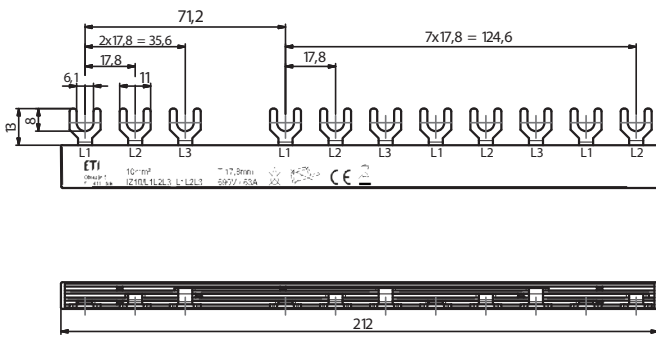

IZ10/L1L2L3_L1L2L3

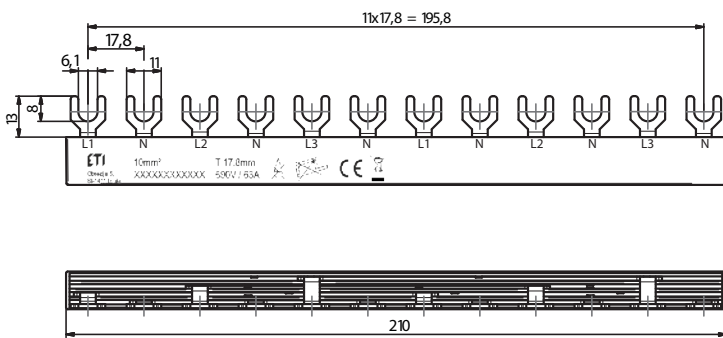
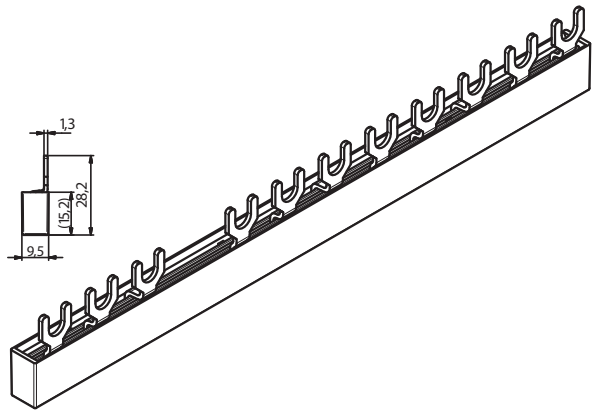

IZ10/L1NL2NL3N/12

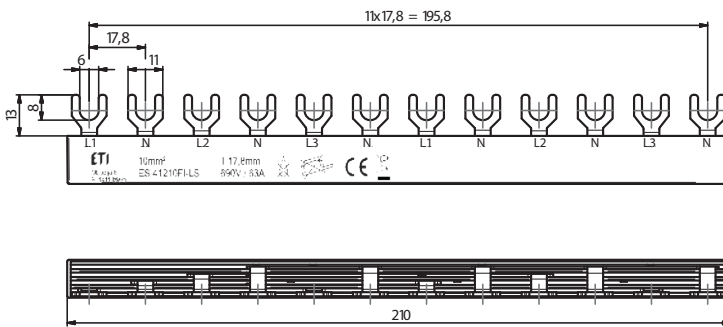
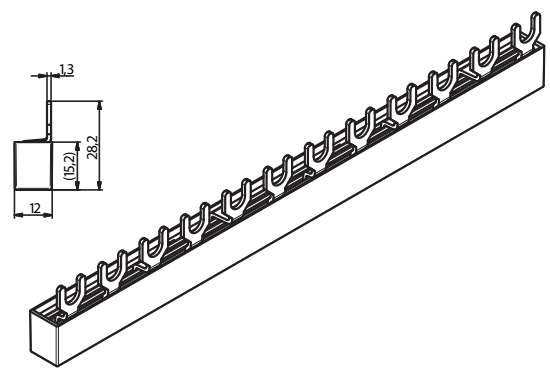

IZ10/L1L2L3NL1NL2NL3N

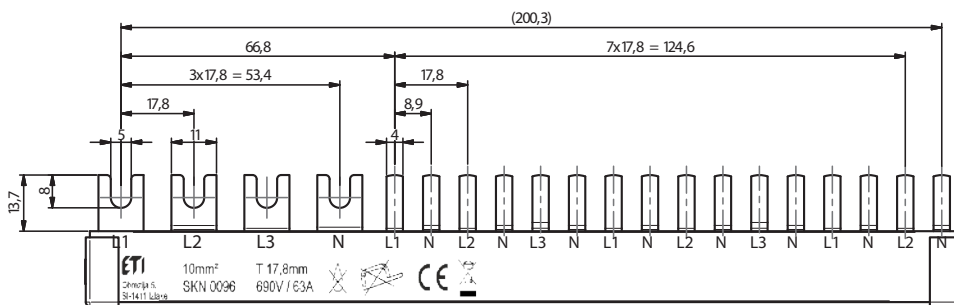
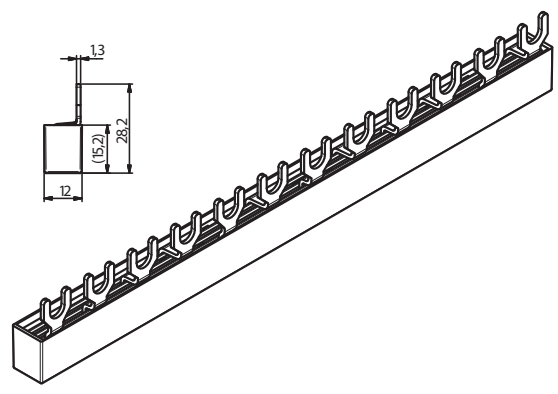

IZ10/L1L2L3NL1/NL2/NL3/N

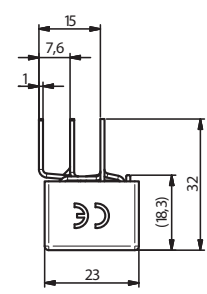

Technical data

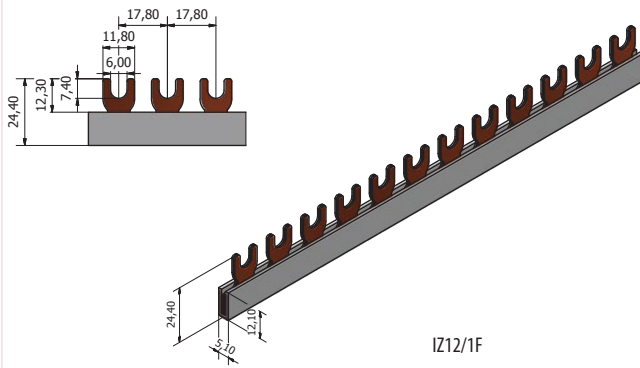

IZ12/1F

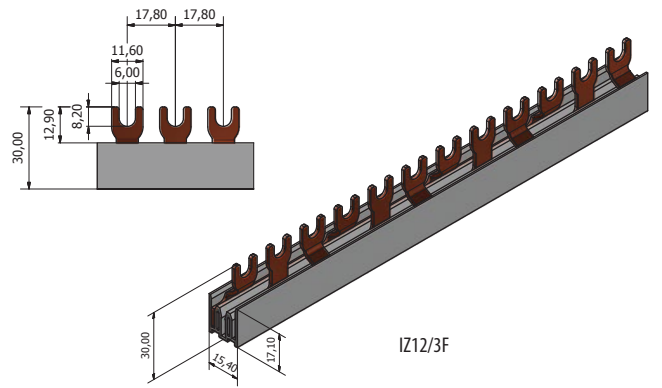

IZ12/3F

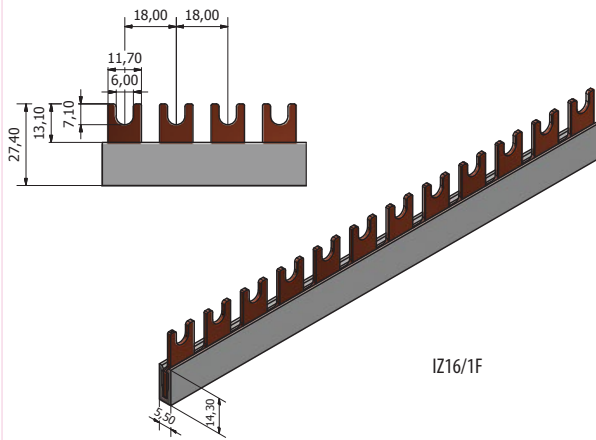

IZ16/1F

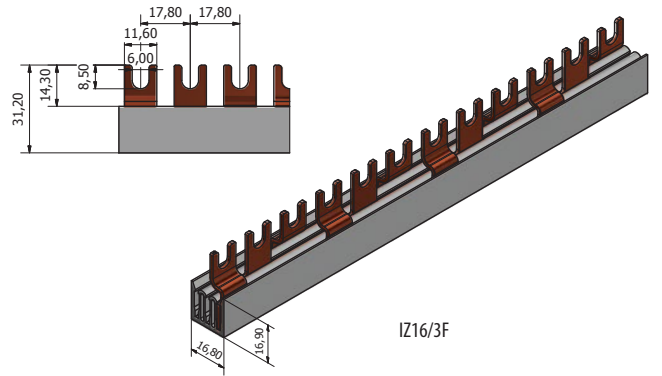

IZ16/3F

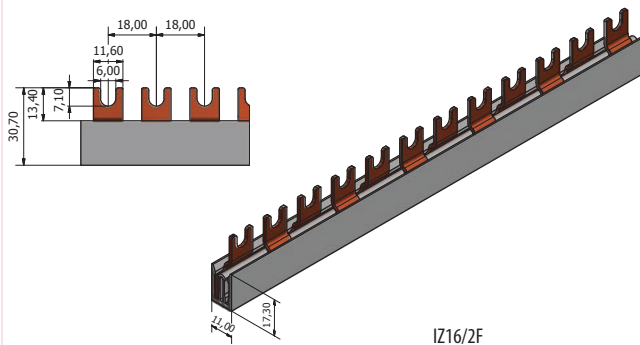

IZ16/2F

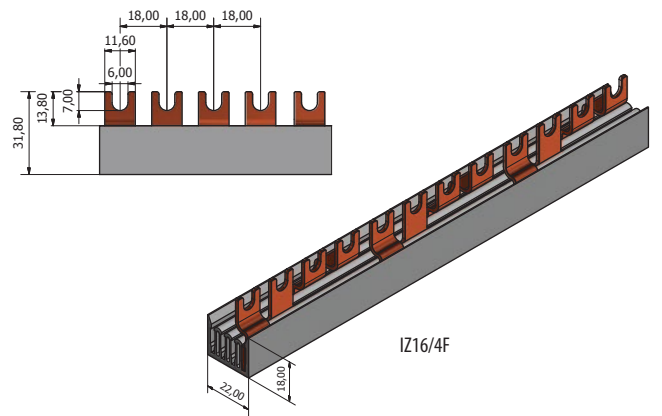

IZ16/4F

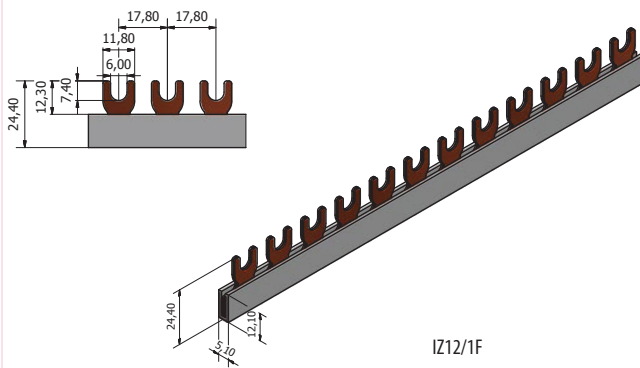

IZ12/1F

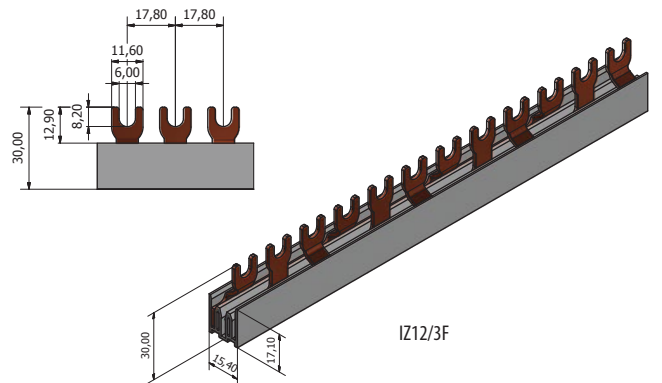

IZ12/3F

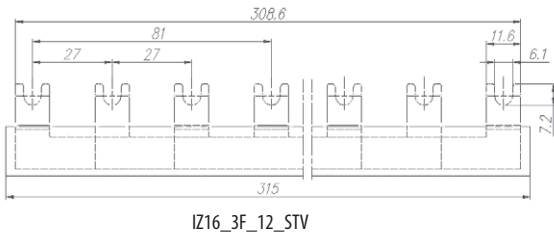

IZ16_3F_12_STV

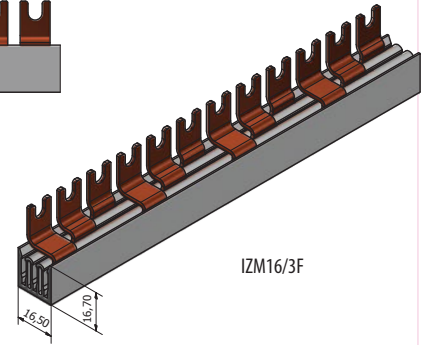
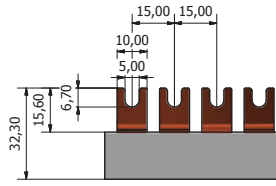

IZM16/3F

IZ-S rails

Nominal voltage	max. 500V
Dielectric strength	2,5 kV
Insulating resistance	> 5 MΩ (DIN 53482)
Temperature range	-20°C ... + 50°C
Glow wire test	850°C (IEC 695-2-1)
Self-extinguishing	V-0
Standards	EN 60947-7-1

cross section	Rated current (A)
10 mm ²	63
12 mm ²	80
16 mm ²	100

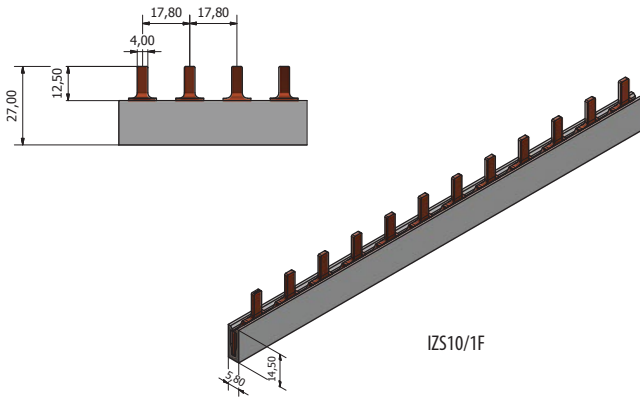

IZS10/1F

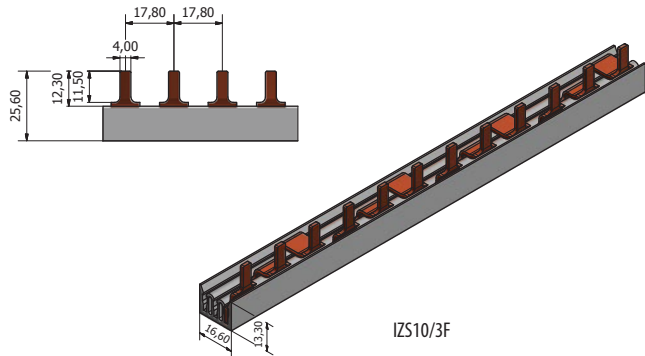

IZS10/3F

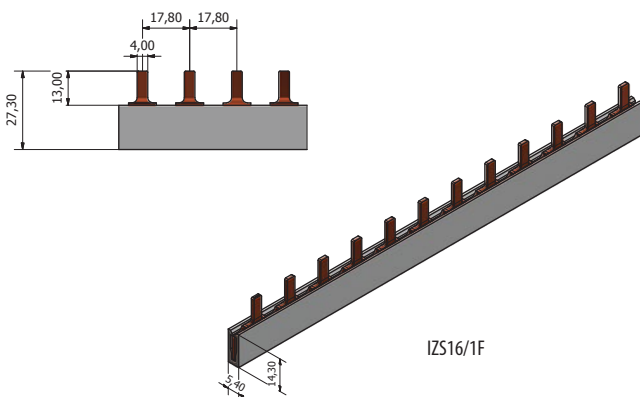

IZS16/1F

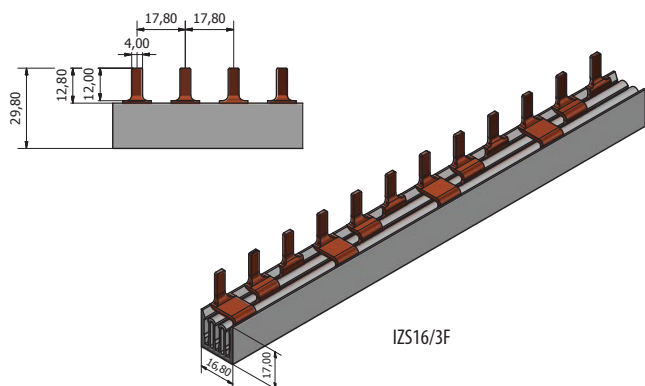

IZS16/3F

Technical data - Section rails for EFD		
Cross section	16 mm ²	50 mm ²
Feeding at beginning/ending		
Max. current I _s /Phase	80	160
Cross section of connection, mm ²	16	50
Feeding in the middle		
Max. current I _e /Phase	130	250
Cross section of connection, mm ²	35	2x50
Heat deflection temperature PVC	80°C flame resistant	
Comparative tracking index PVC	300V	
Standards	EN 60947-1:2007/ IEC 60947-1:2007	
Climate stability	DIN EN 60068	
Insulation coordination	Degree of pollution 2	
Electrical data		
Impulse voltage strength	≥4,5 kV	
Min. air distance	> 5,5 mm	
Min. creeping distance	> 5 mm	
Max. operating voltage	690 V AC/DC	
Protection class	IP20	
Short circuit rating	ICC 15kA NH 250A gL 500V	
Dielectric strenght	≥ 32 kV/mm	
Material		
	Material	Surface
Busbar	Copper	plain
Insulation	PVC lead-free	grey RAL 7035
Endcover	moulded	

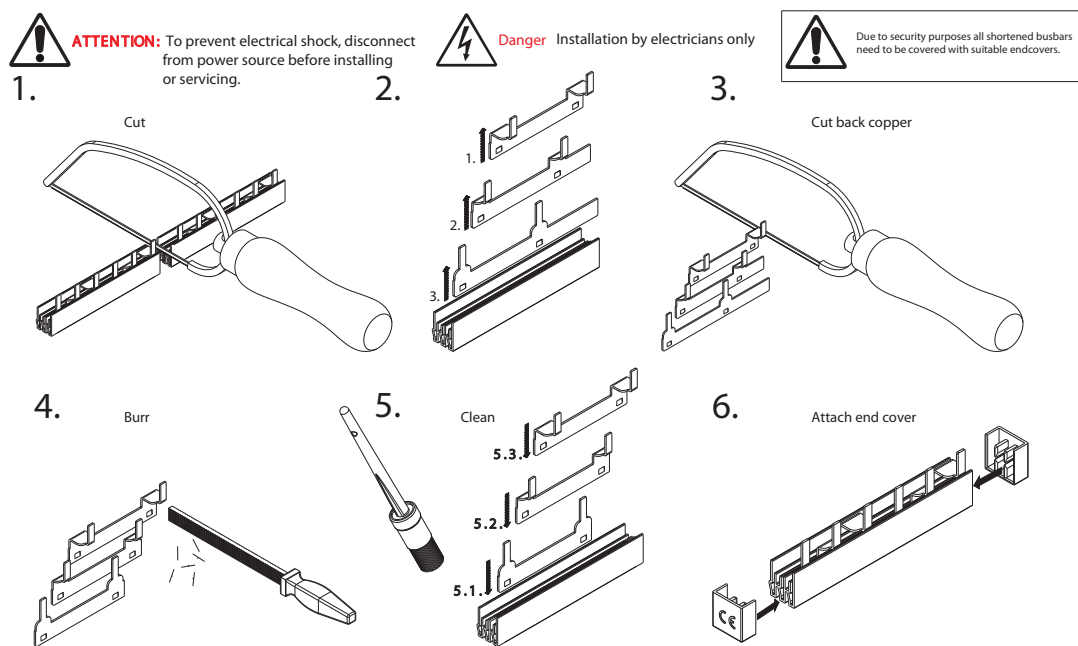

IZ16/1F/37

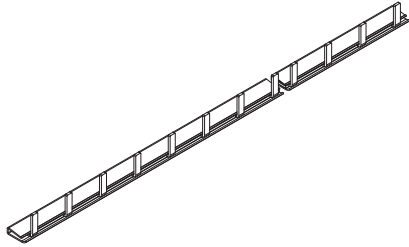
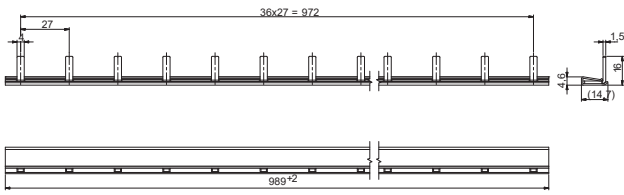

IZ16/1F/28

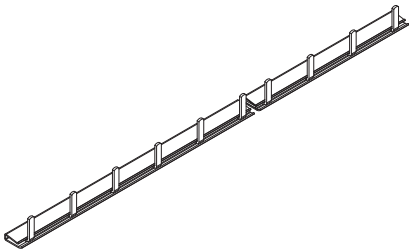
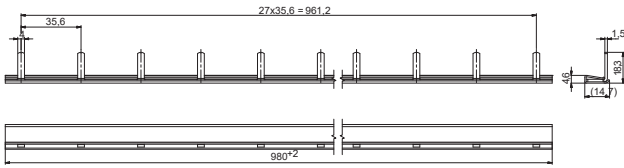

IZ50/1F/37

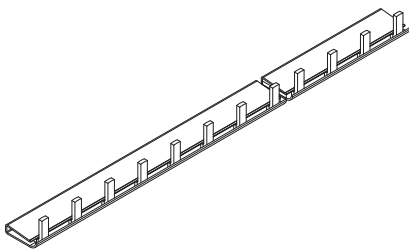
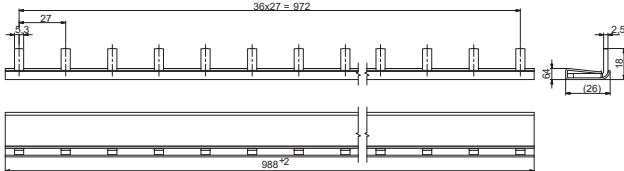

IZ50/1F/28

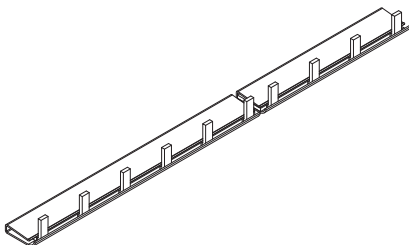
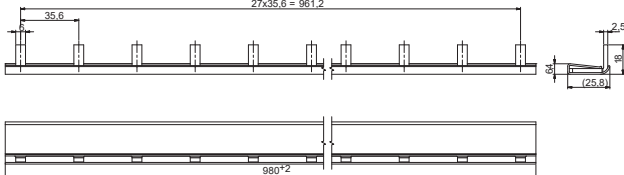

IZ16/3F/37

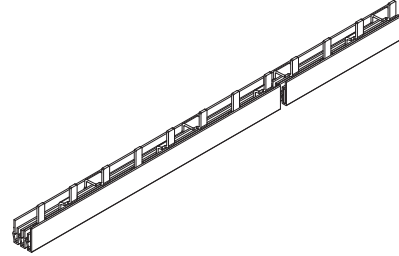
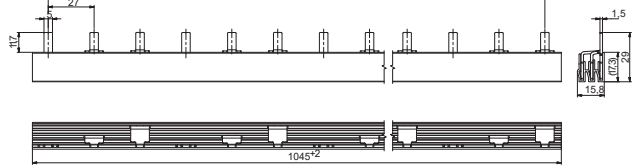

IZ16/3F/28

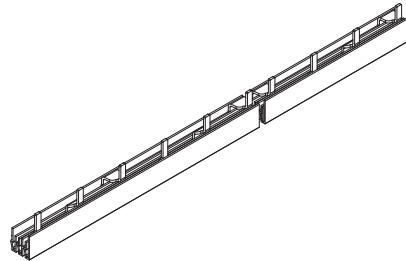
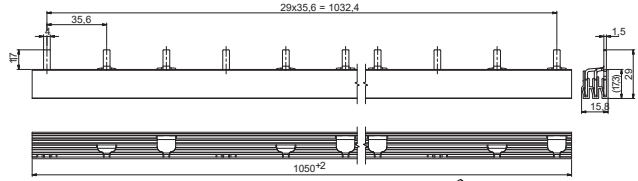

IZ50/3F/37

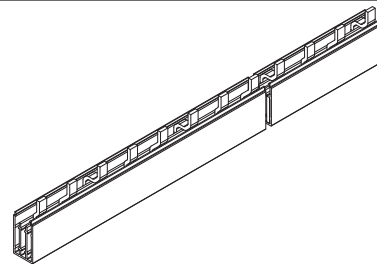
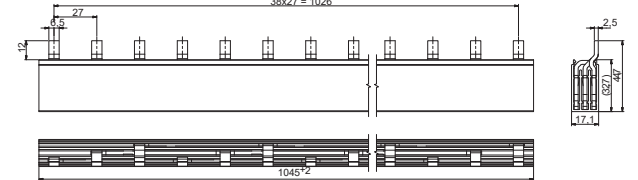

IZ50/3F/28

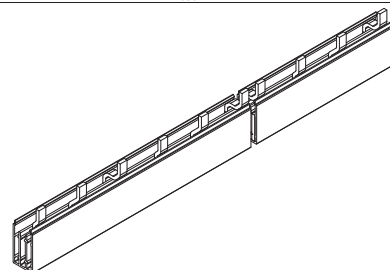
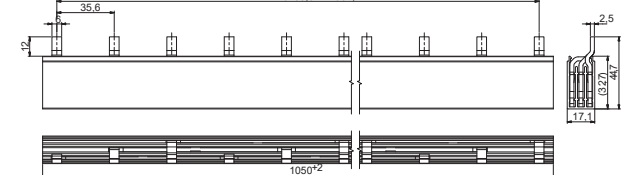

Technical data

Z-16/1F/37

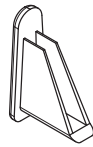
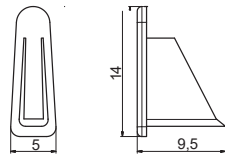

Z-50/1F/37

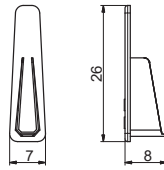

Z-50/3F/39

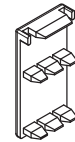
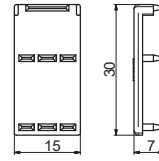

Z-16/1F/28

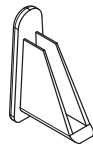
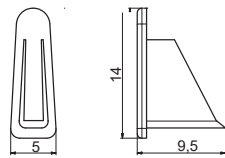

Z-50/1F/28

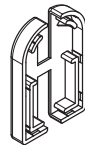
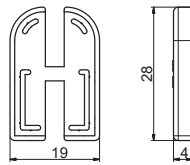

Z-50/3F/30

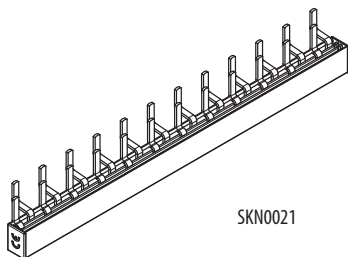
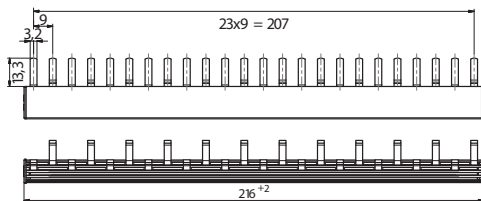
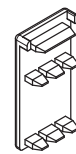
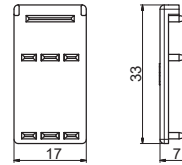

SKN0021

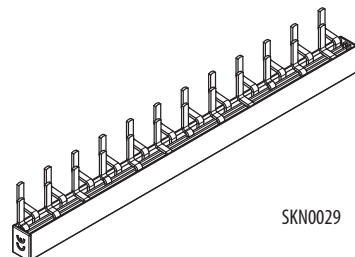
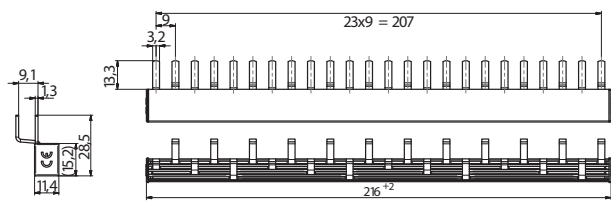

SKN0029

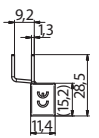

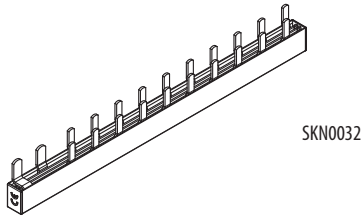
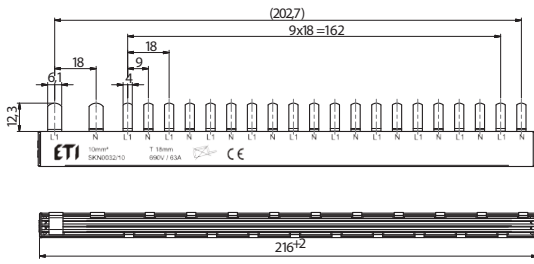

SKN0032

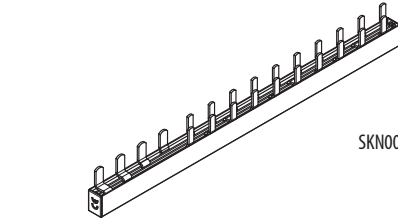
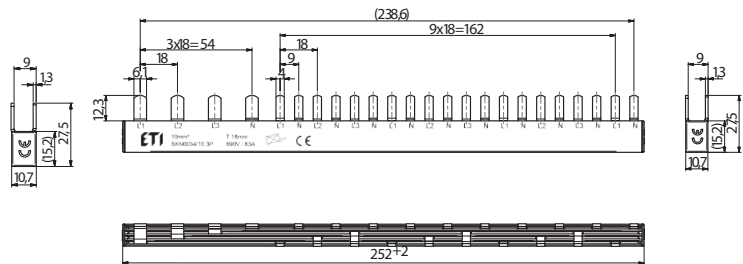

SKN0034 3P



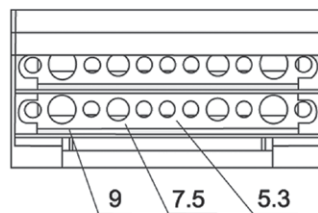
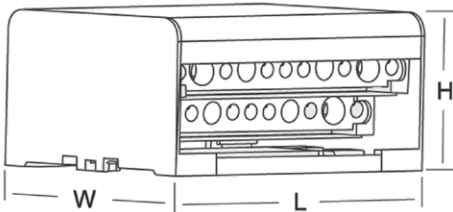

Din rail distribution blocks EDB

Technical data:

Degree of protection	IP20 (with closed cover)
Short circuit withstand capability I_{cc}	20kA
Rated current	125A
In accordance with	EN 60947-1, EN 60947-7-1

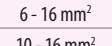
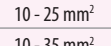

Wire cross section by terminal size

Wire with ferrule	Wire without ferrule	Terminal size [mm]
 1,5 - 6 mm ²	 2,5 - 6 mm ²	Ø 5,3
 6 - 16 mm ²	 10 - 25 mm ²	Ø 7,5
 10 - 16 mm ²	 10 - 35 mm ²	Ø 9

Technical data

METER board

METER board

type	dimension					
	A	B	C	D	E	F
MPO	250	80	85	47	63	170
VPO	370	75	170	136	50	241
MP	250	80	85	47	63	270
VP	370	75	170	136	50	241

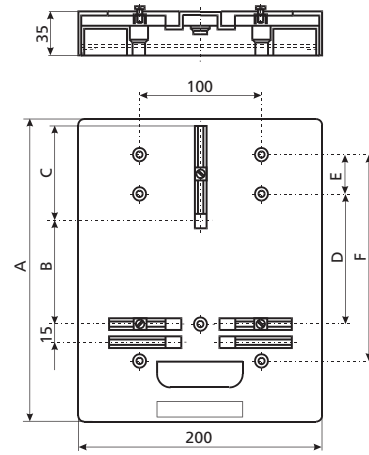

Universal board covering UPO

Technical data:

Standard length of profile	1 m
Number of carriers per 1 m of profile	4 pcs
Distance between mounting rails	125 mm
Width of distance for built-in elements	46 + 0,5 mm

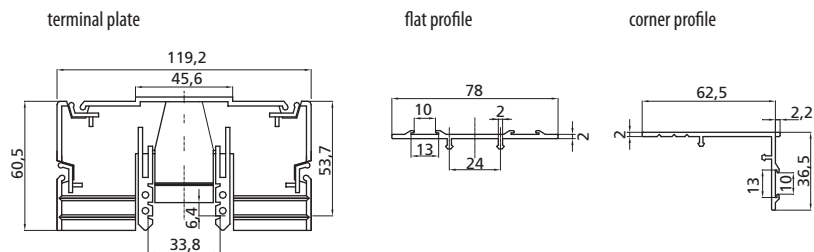

Installation channels

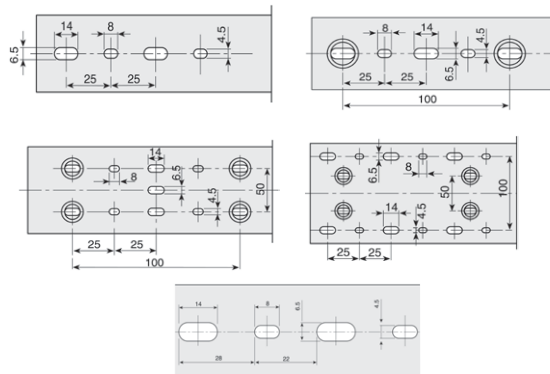

Metric cable glands IP67

Sealing glands with metric thread

type	sealing range Ømm	assembly spanner	thread	Dimensions				assembly opening	Tightening torque Mk / Nm	Resistance to impact (J)
				L	L _{min}	L _{max}	ØD			
M-12G	2 ÷ 7	16	M12x1,5	8	17	21	16,5	12,5	2,5	40
M-16G	4 ÷ 9	20	M16x1,5	8	21	25	21	16,5	3,75	40
M-20G	8 ÷ 12	24	M20x1,5	10	25	30	26,5	20,5	5	40
M-25G	10 ÷ 16	30	M25x1,5	10	30	37,5	33	25,5	7,5	40
M-32G	12 ÷ 20	36	M32x1,5	12	35	45	40	32,5	10	40
M-40G	16 ÷ 26	46	M40x1,5	12	40	50	51	40,5	10	40
M-50G	20 ÷ 37	55	M50x1,5	14	50	60	61	50,5	10	70
M-63G	25 ÷ 47	70	M63x1,5	14	55	65	78	63,5	10	70

Using glands for cable with a diameter

1	2	3	4	5	6	7	8	9	10	11	12	13	14	15	16	17	18	19	20	21	22	23	24	25	26	27	28	29	30	31	32	33	34	35	36	37	38	39	40	41	42	43	44	45	46	47	48										
																																				M 63																					
																								M 50																																	
																		M 40																																							
												M 32																																													
								M 25																																																	
						M 20												PG 36																																							
				M 16												PG 29																																									
			M 12												PG 21																																										
		PG 16																																																							
	PG 13																																																								
	PG 11																																																								
	PG 9																																																								
	PG 7																																																								

Metric lock nuts

type	thread	dimensions (mm)		Tightening torque
		A	B	
M-12N	M12x1,5	16	4,5	2,5
M-16N	M16x1,5	22		3,75
M-20N	M20x1,5	27	6	5
M-25N	M25x1,5	34		7,5
M-32N	M32x1,5	41	7	10
M-40N	M40x1,5	50		10
M-50N	M50x1,5	60	8	10
M-63N	M63x1,5	75		10

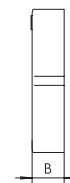
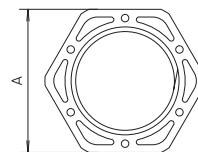

Metric sealing rubber washers

type	dimensions (mm)		
	Ø D	Ø D ₁	B
M-12S	16	12	1
M-16S	20,5	16	
M-20S	25	20	1,5
M-25S	31	25	
M-32S	38	32	2
M-40S	48	40	
M-50S	59,4	50,4	
M-63S	76	63	

